

COMPONENTS AND ACCESSORIES

HORIZONTAL RAILS HeiPac Vario

Horizontal rail Vario V 1, front



To accommodate guide rails and for the attachment of front panels

- Front projection 2.5 mm corresponding to IEC 60 297-3-101
- HP pitch pattern of holes for the precise installation of guide rails
- M4 thread on end face
- Straight-through core hole
- Horizontal rail 192 HP without machining on the end faces. Suitable for cutting to length

Material

Extruded aluminium section

Surface finish

Clear-chromated

Usable width (HP)	Packs of	Order No. unprinted	Order No. printed
4 (left)	1	3684.592	-
4 (right)	1	3684.955	-
8 (left)	1	3684.593	-
8 (right)	1	3684.956	-
12	1	3684.594	-
16	1	3684.595	-
20	1	3684.596	-
21	1	3685.985	-
40	1	3684.960	-
42	1	3684.560	9921.788³⁾
63	1	3684.561	-
84	1	3684.562	9921.789³⁾
84	2	3685.267¹⁾	-
192	1	3688.000²⁾	-

¹⁾ Including 4 assembly screws

²⁾ Anodised

³⁾ with HP pattern printing

+ Also required

Assembly screws M4 x 12
Packs of 100, order no. 3654.300
see page 202

+ Accessories

Threaded inserts, packs of 1, order no. 3684.610
see page 144

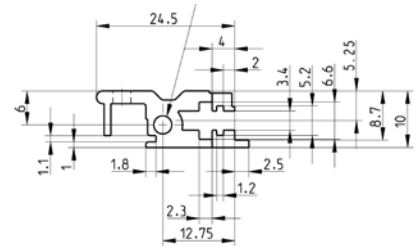
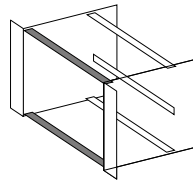

Horizontal rail Vario V 2, front, with double screw fastening



To accommodate guide rails and for the attachment of front panels. The double screw fastening ensures a high level of stability even under extreme loads.

- Front projection 2.5 mm corresponding to IEC 60 297-3-101
- HP pitch pattern of holes for the precise installation of guide rails
- M4 thread on end face
- Straight-through core hole
- Load test to DIN EN/IEC 61 587-1, requirement level SL1
- Shock and vibration tests undertaken as per IEC 61 373 (DIN EN 50 155), Category 1, Class B

Material

Extruded aluminium section

Surface finish

Clear-chromated

Usable width (HP)	Packs of	Order No. unprinted	Order No. printed
84	1	9908.721	9921.793¹⁾

¹⁾ with HP pattern printing

+ Also required

Assembly screws M4 x 12
Packs of 100, order no. 3654.300
see page 202

+ Accessories

Threaded inserts, packs of 1, order no. 3684.610
see page 144

